



Das Vital-Office® Konzept
Für mehr Lebensqualität in einer gesunden Bürowelt

The Vital-Office® Concept
- For a better quality of life in a healthy office world -

活力办公室®-公司的理念
—提高生活质量，创健康办公环境

Peter Jordan
皮特·尤丹



Vital-Office success story in China

1. Professional concepts instead of cheap and fancy products
2. German production technology brought to China factories
3. Immediate development of new and adapted products to fit into Chinese market
4. Use of local material and advantages e.g. Green Bamboo

Your team in China and Germany





Vital-Office success story in China

5. Quickly furnish well known corporations e.g.

- a. Kärcher, Changshu
 - b. Jungheinrich, Shanghai
 - c. H.C. Starck, Gangzhou
-
- Short lead time (2-3 weeks)
 - Competitive prices
 - Reliable professional service from planning to installation



Vital-Office architectural design

1. Design and architectural services all around offices

- a. 20 years experience and leading development
- b. Scientific research presented in lectures e.g. to international conferences from Hongkong to New York

2. Ergonomic, space efficient and enhancing (Feng Shui) office planning

- a. Expertise in professional office planning and ergonomics integrates Feng Shui form school

Your team in China and Germany





Vital-Office architectural design

3. Customer's advantage:

- a. Attractive office environment to keep workers (reduce fluctuation)
- b. Healthy ergonomic workplace to prevent physical and psychological illness
- c. Reduced Stress -> better performance
- d. Social needs respected -> better collaboration

Your team in China and Germany





Ergonomic and Sustainable Office Solutions

How to make a company more competitive?

How to reduce their costs?



Office cost overview

- **Reliance of office performance** 60 to 80%.
- **Yearly Costs consisting of:**
 - personal expenses (80%)
 - building expenses (14-15%)
 - material and office technology (4-5%)
 - furniture expenses (1-2%)
- **1/4 of all sick certificates is issued because of musculoskeletal disorders.** (yearly)
 - work disability 100 million days
 - production downtimes 8,5 billion €
 - together with therapy costs 50 billion €



What do you see and feel?



Usual Office

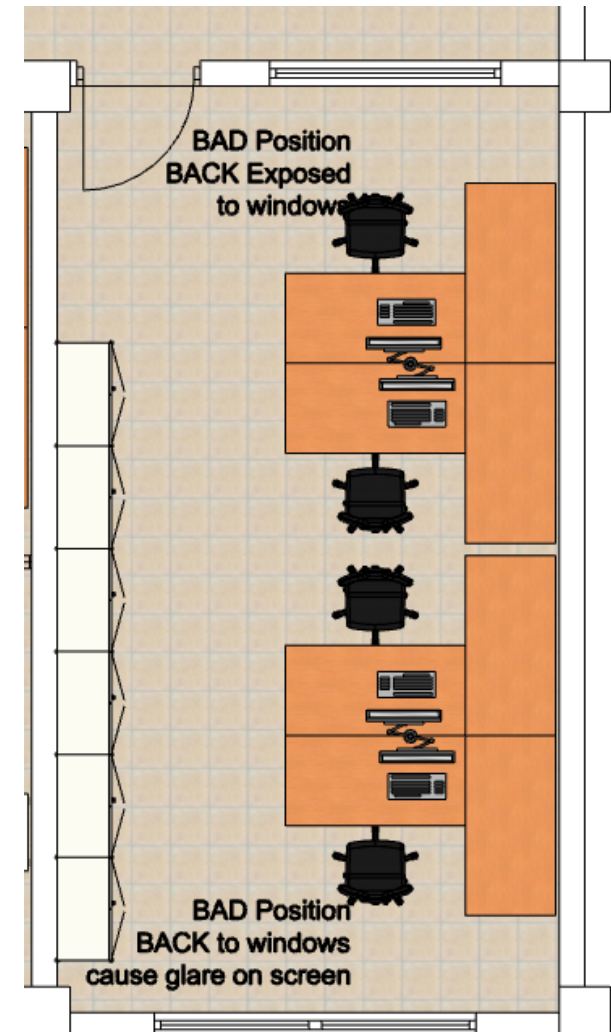



What do you see and feel?

Usual Office





Example:

Stiff & Mechanical layout:

- Cell-block layout, no fengshui points
- Dull rows and lines bring psychological gloomy and tension.
- Unified style, no management level

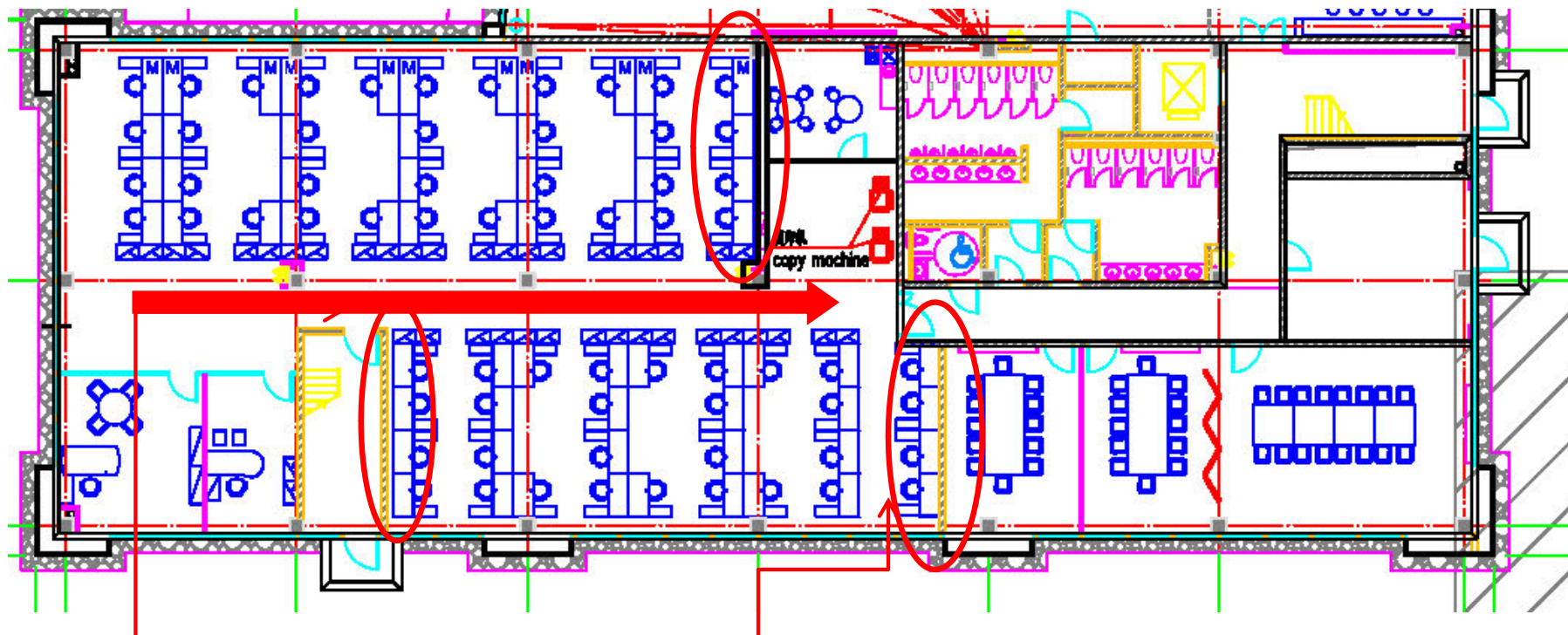

racing corridor:

- Straight passway, uneven view, air, and lightening
- Fast runaway → to be on the run

Work against the wall

- no communication/exchange
- closed view
- long walkway stop communicating



Total outcome of bad offices

- High Turnover (employee)
- Low Performance
- Low Flexibility
- Low Creativity & Inspiration
- Bad Company Image

=> high cost & low competitiveness



Issues

- Health
- Security / backing
- Creativity / Inspiration
- Structure
- Team Work
- Flexibility
- Durability
- Company Image
- Focus / control
- Well-Being
- Command Position
- Communication
- Material / Quality
- ...



Rectangular Structures & Rounded Structures

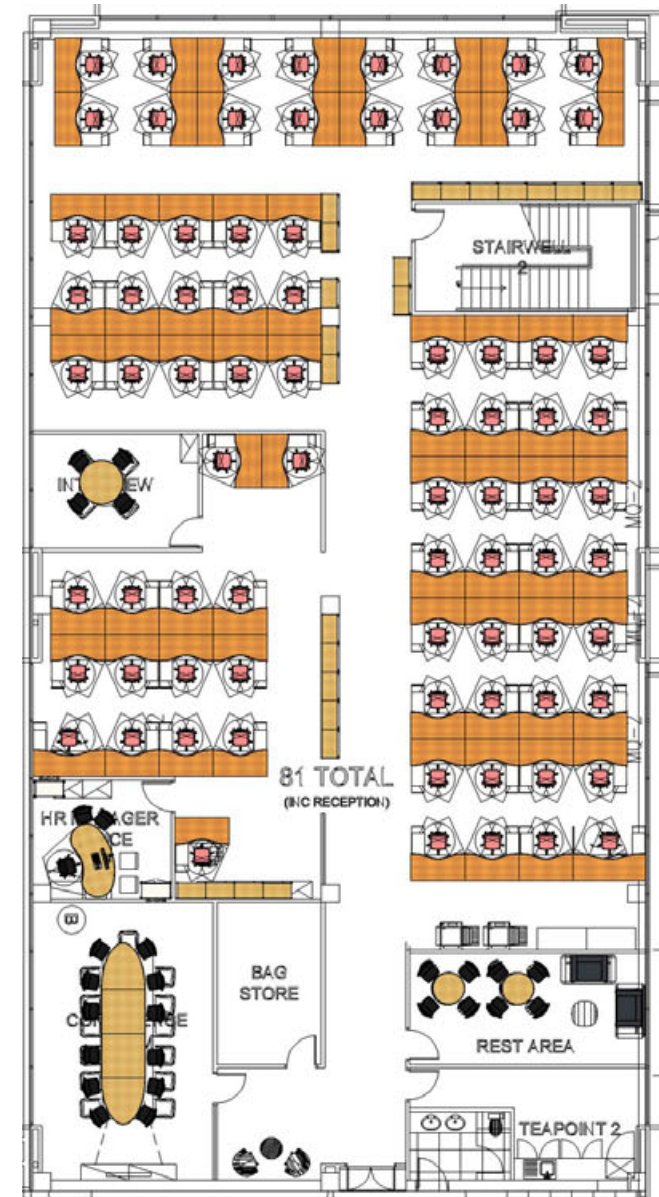
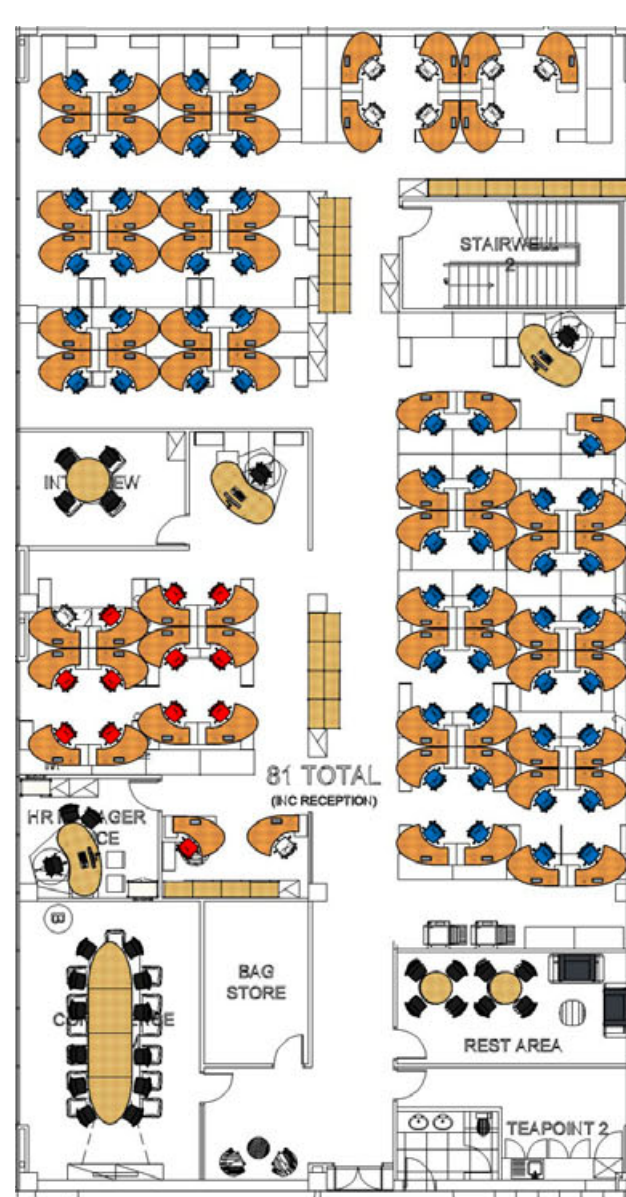



Rectangular Structures & Rounded Structures

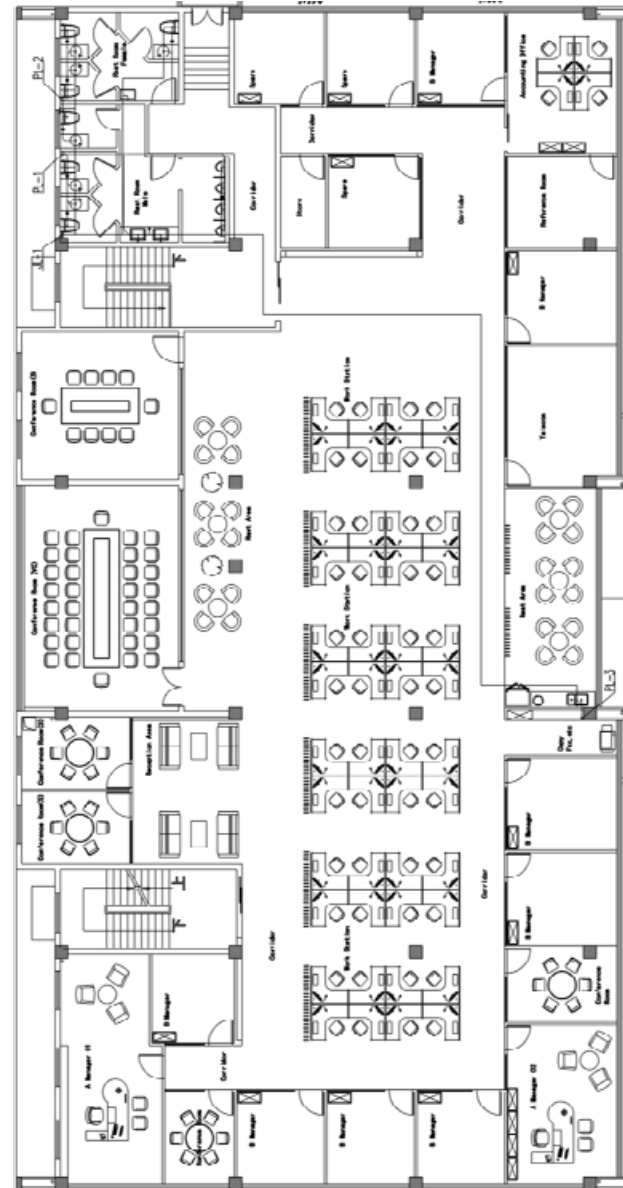



Rounded Structures

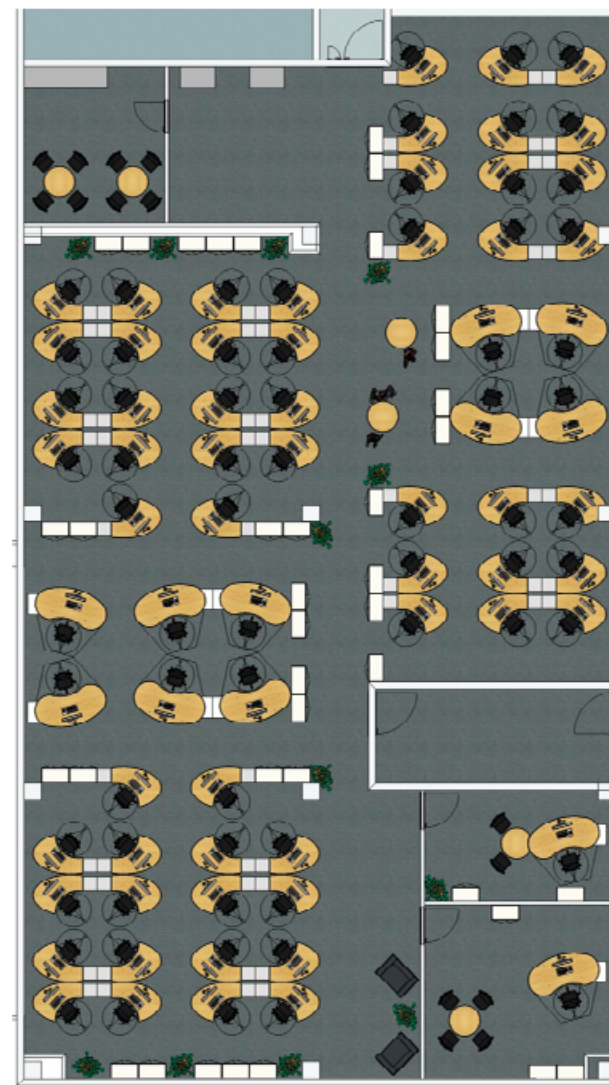
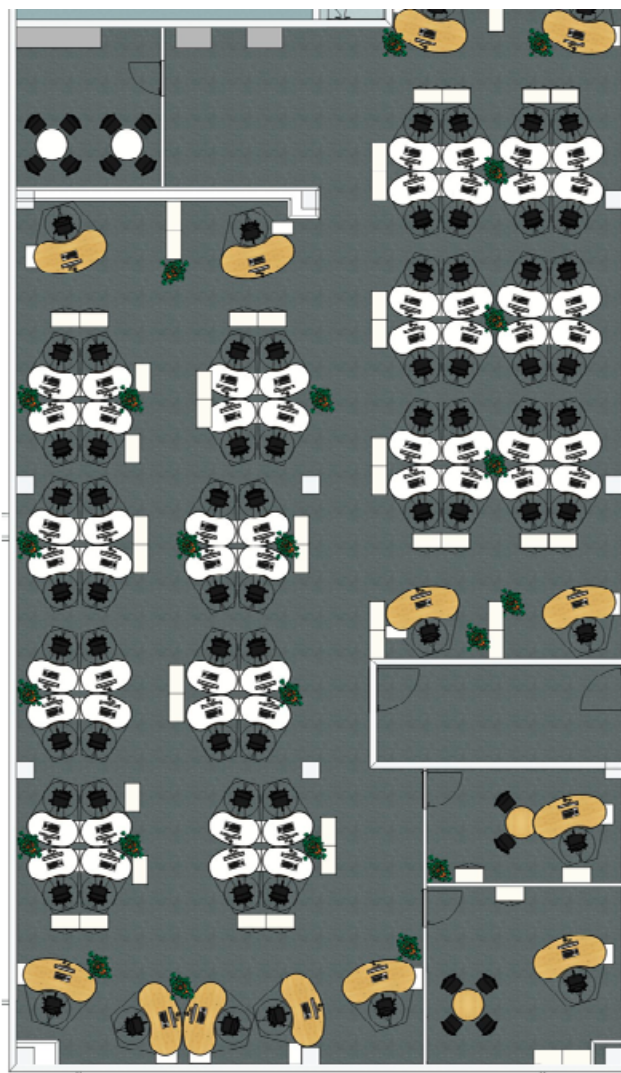



Organic structure





more Structures





Flexibility

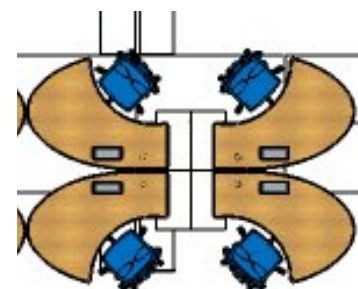
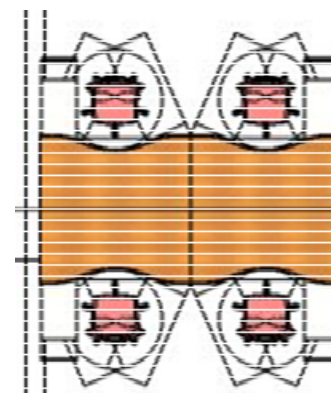
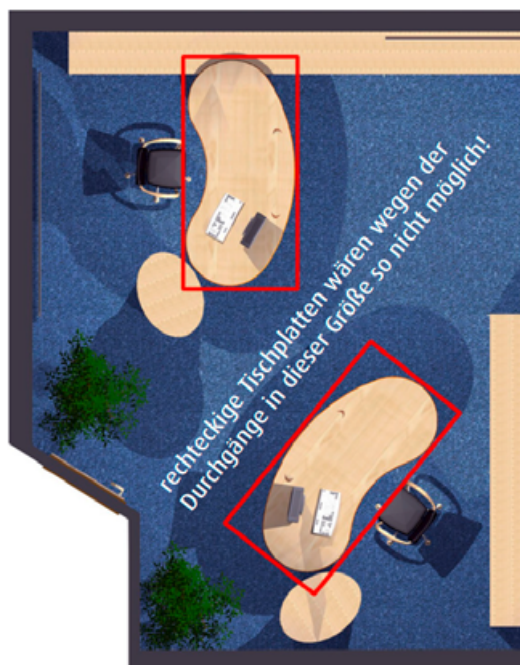
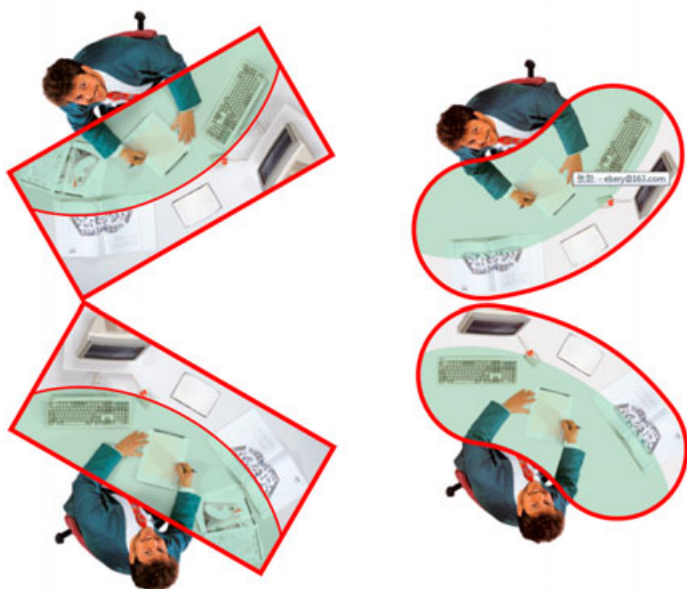



Command Position of Managers

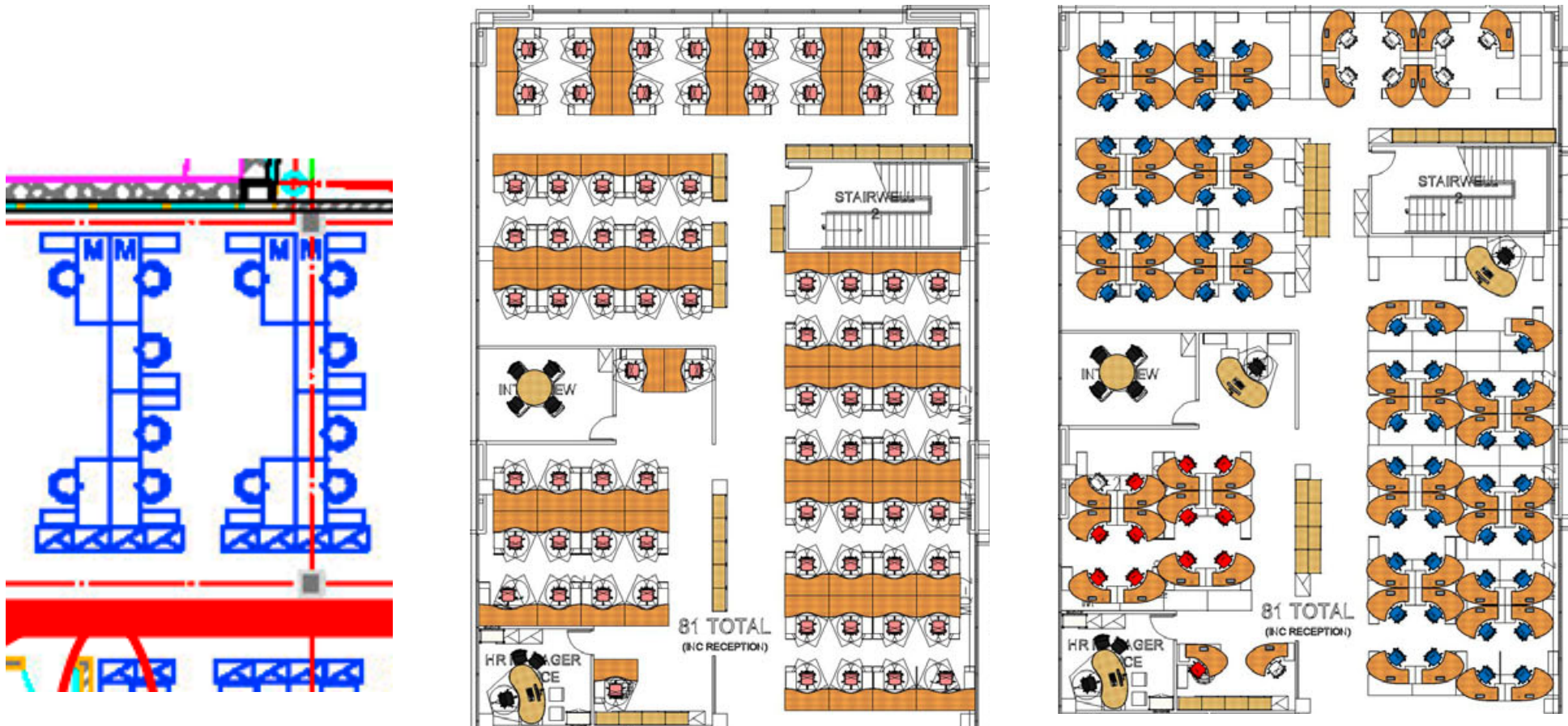



Working against or with...

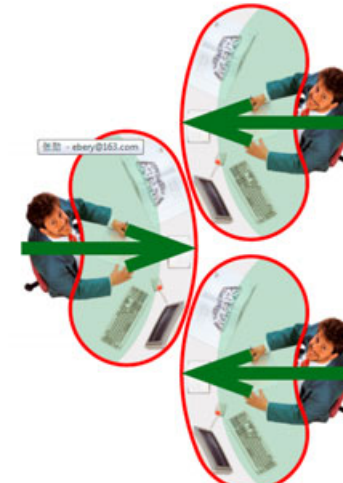
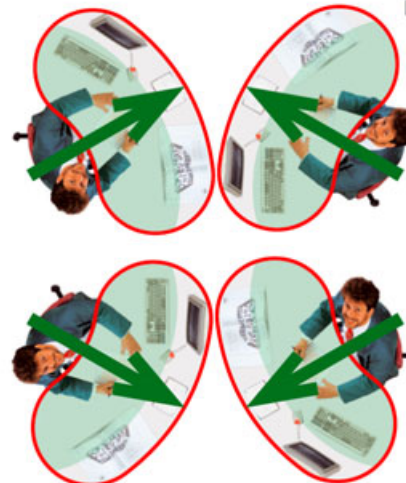
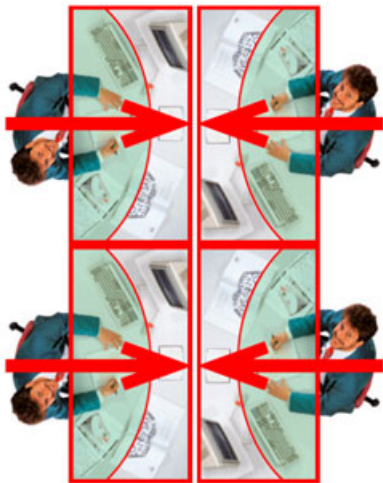
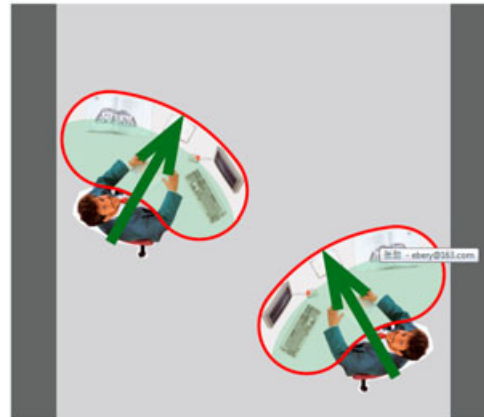



Teambuilding

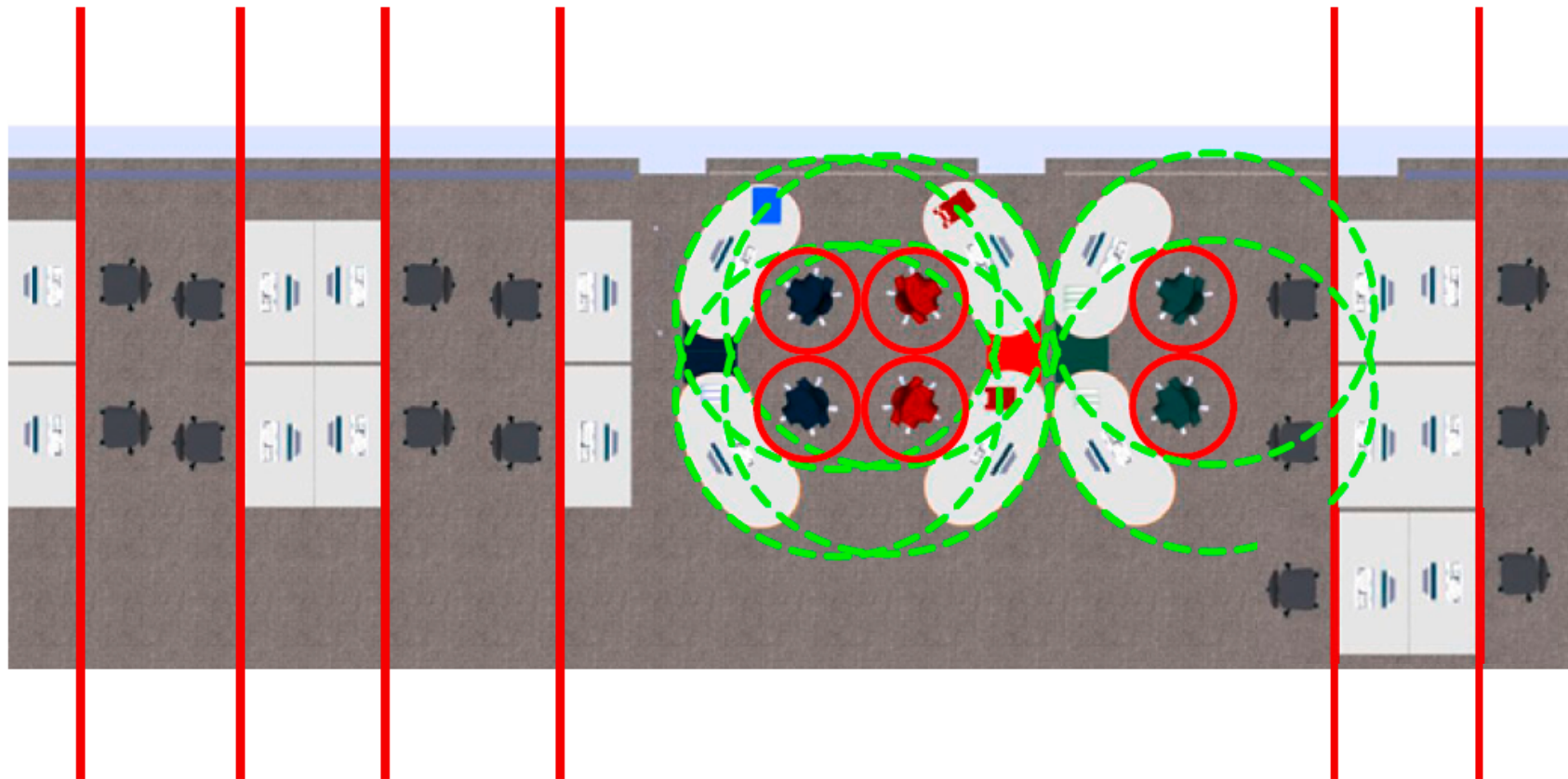



Backing & Privacy Communication

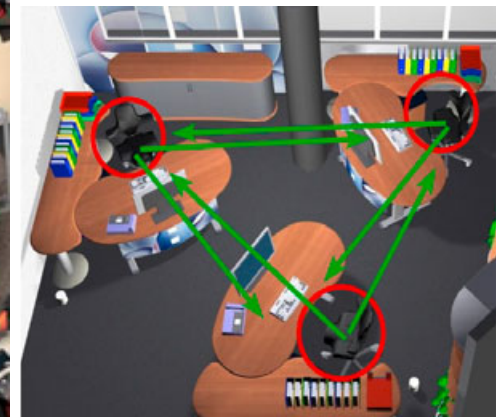
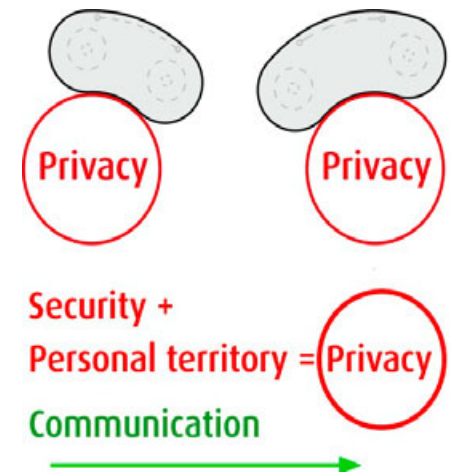
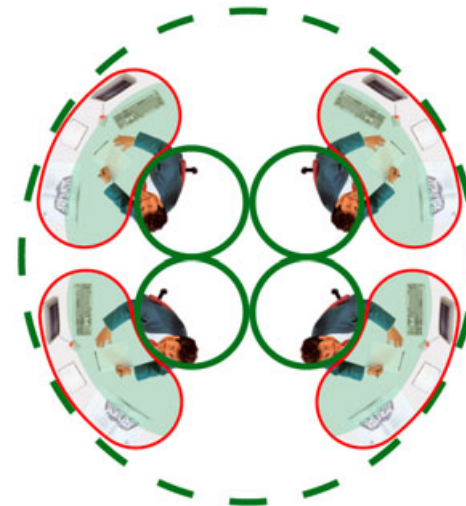
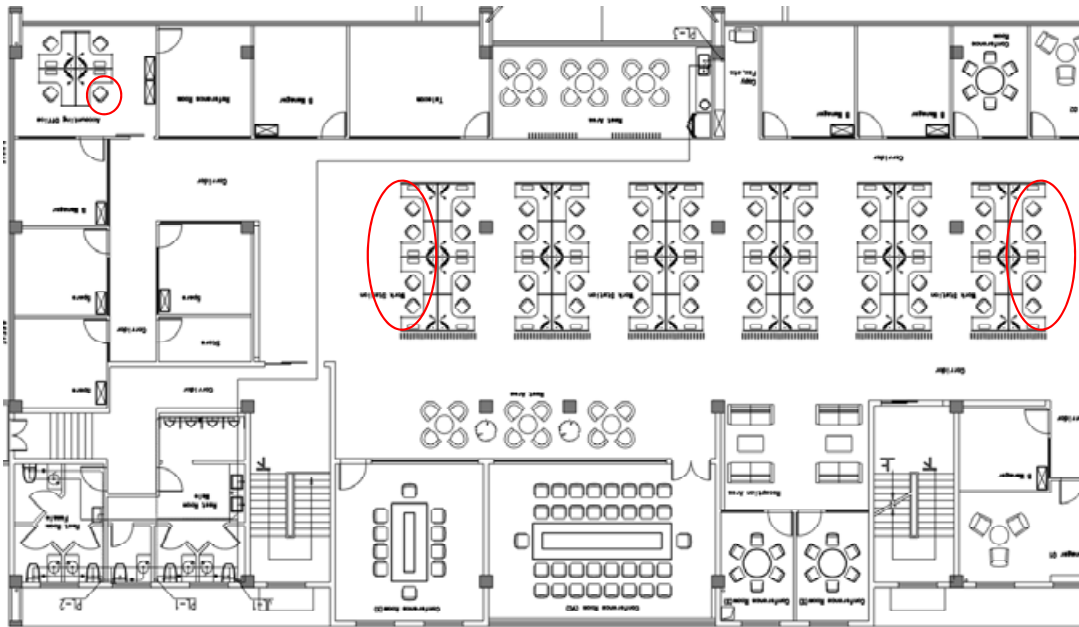



Communication Control Focus





Worplace Comparison

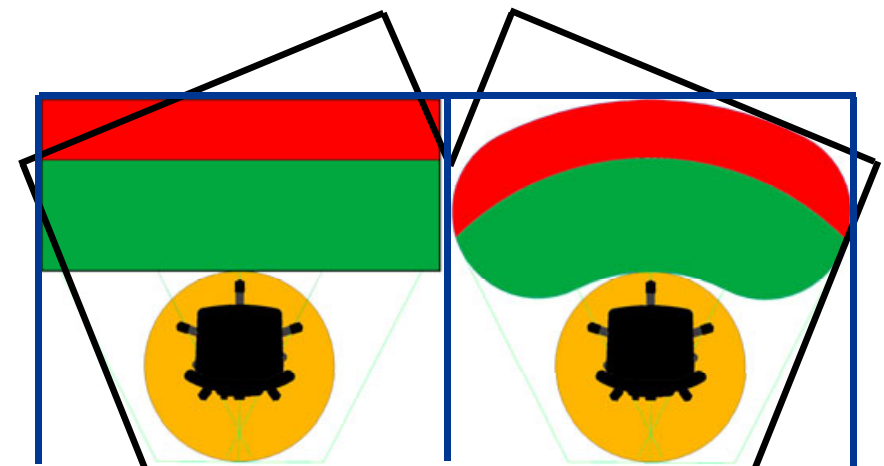
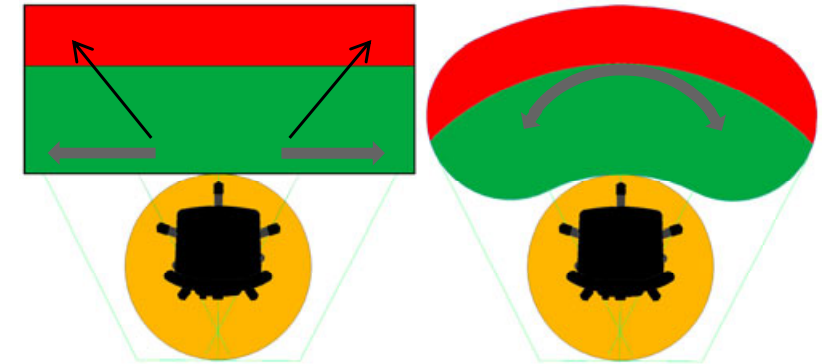
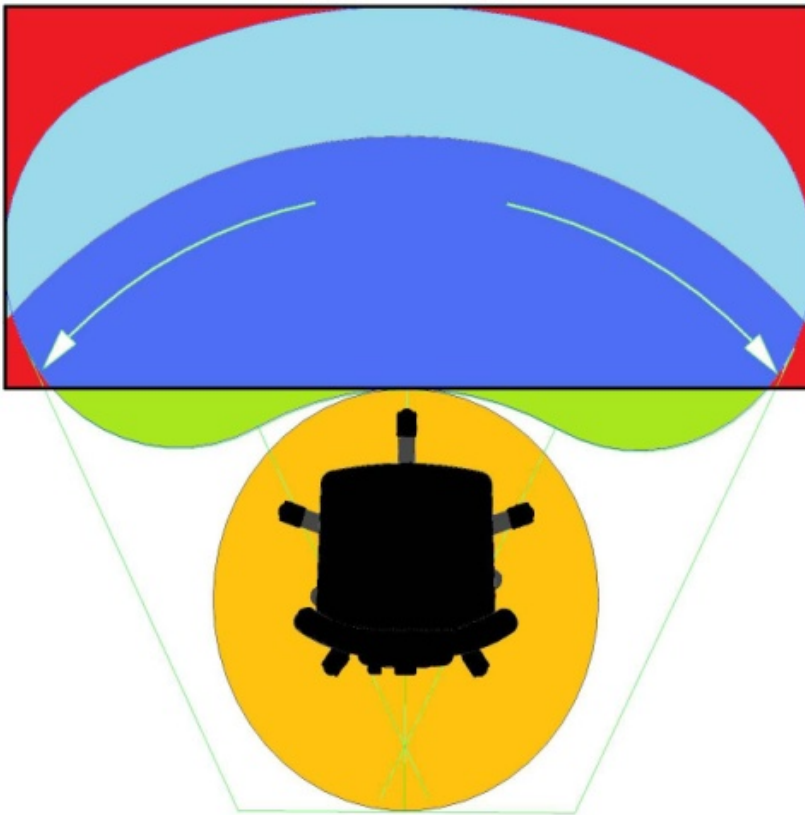



Storage

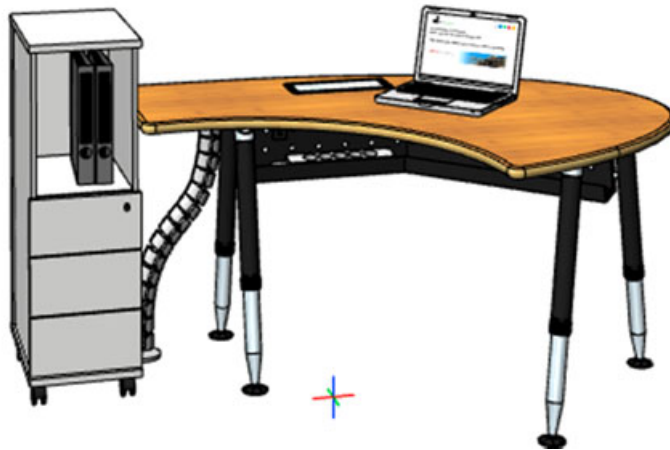



Inner Circle



Softtouch/ Armrest

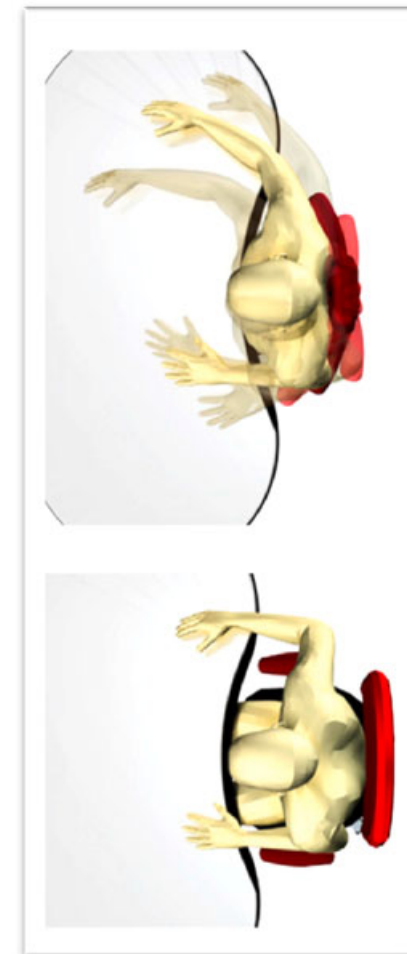



Height Adjustability





Material / Quality





Cabeling





Company Image

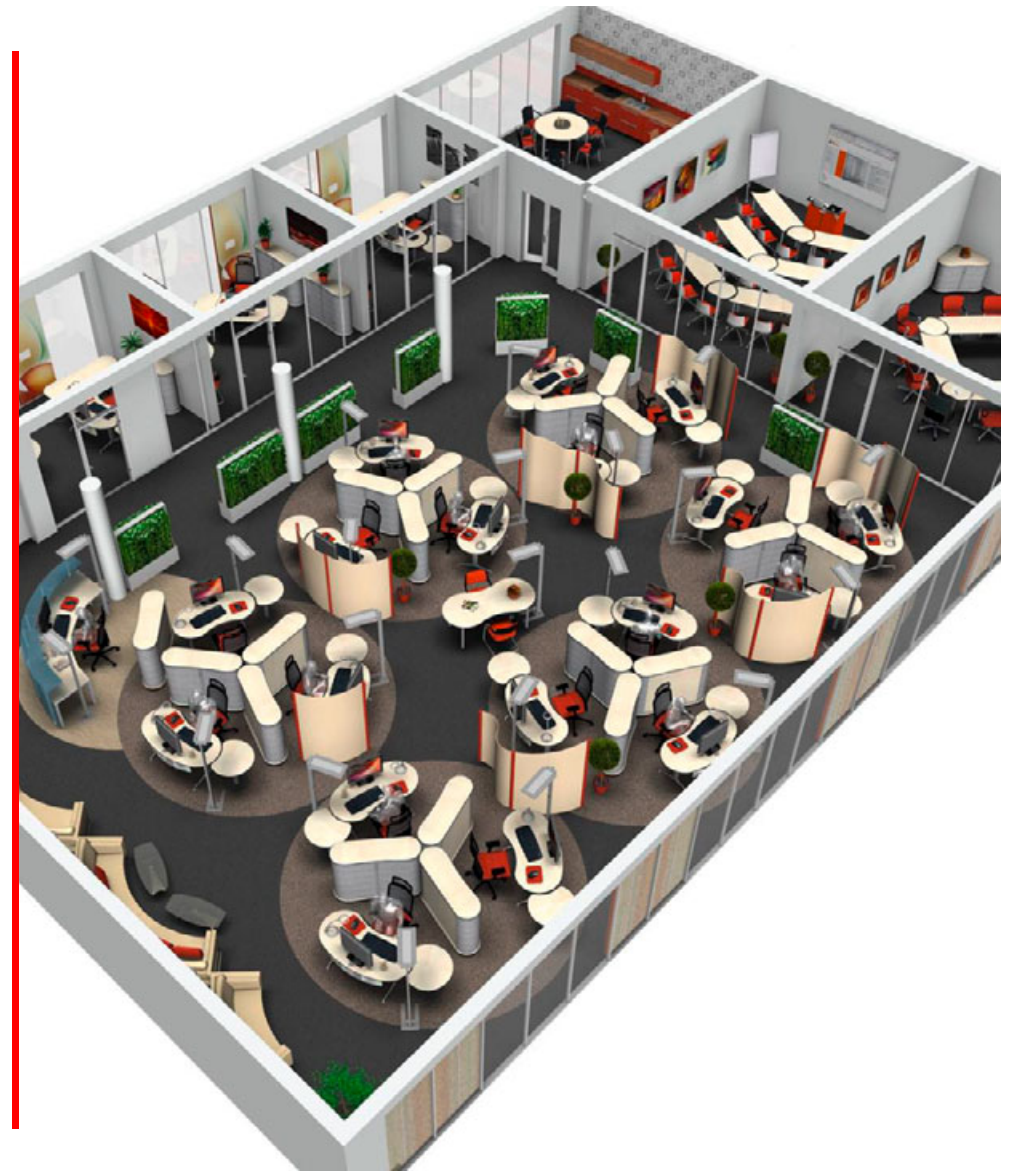



Issues

- Health
- Security / backing
- Creativity / Inspiration
- Structure
- Team Work
- Flexibility
- Durability
- Company Image
- Focus / control
- Well-Being
- Command Position
- Communication
- Material / Quality
- ...



The End

Thank you for your attention.

Do you have more questions?